

---

*Comfort-Aire*®

**Century**®



---

REPLACEMENT PARTS LIST

**Dual Zone Low Temperature  
Ductless Mini-Split**

A-VMH18DU-1

# EXPLODED VIEW

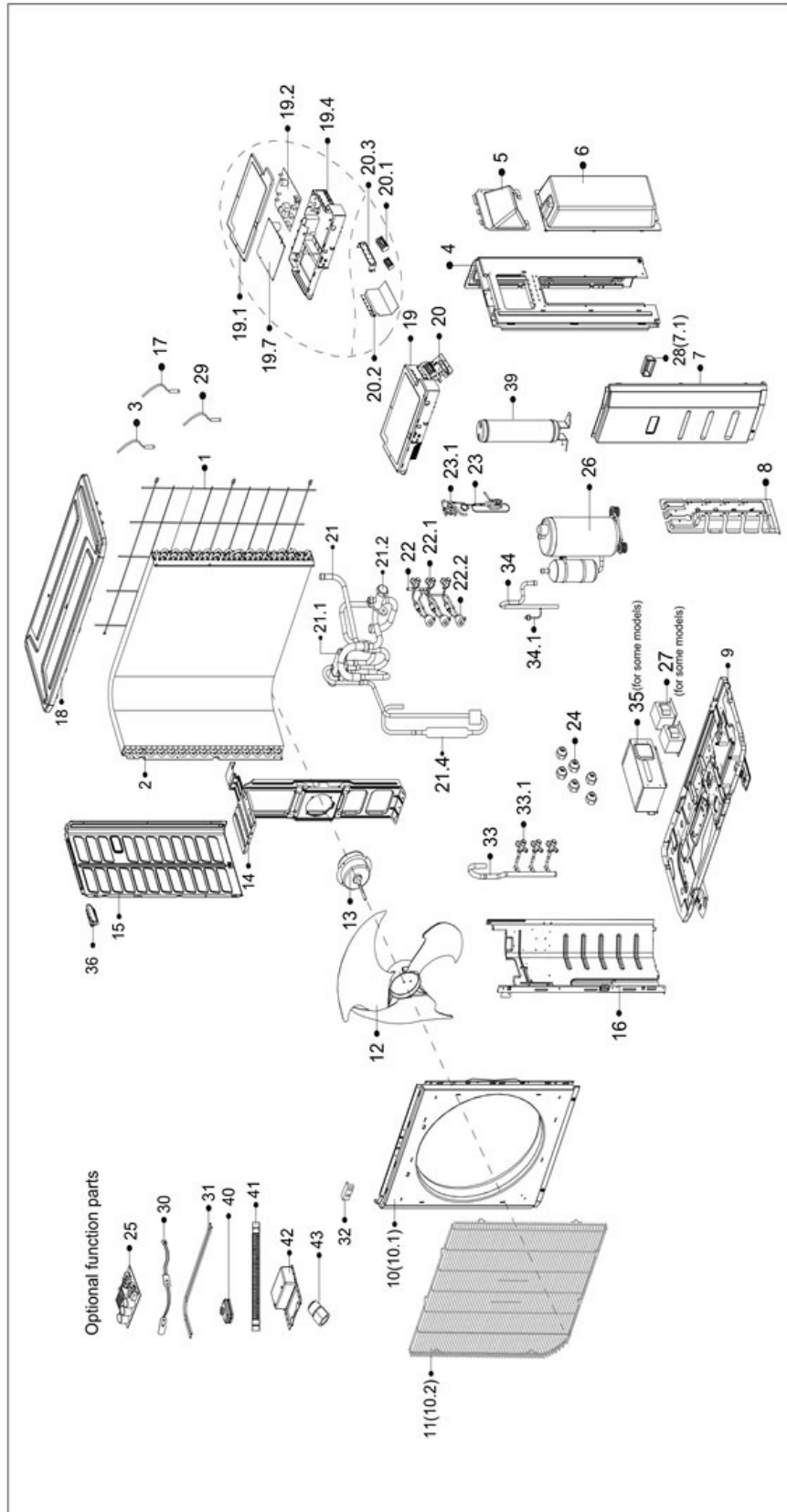

## REPLACEMENT PARTS

Location	Part Name	Quantity	Part No.
1	Rear net	1	12222000006604
2	Condenser assembly	1	15822000002068
3	Pipe Temperature Sensor	1	11201007000136
3	Pipe Temperature Sensor	1	11201007000259
4	Rear right clapboard assembly	1	12222300000510
5	Big handle	1	12222300000529
6	Water collector	1	12122300000110
7	Front right clapboard assembly	1	12222500A00135
8	Valve plate	1	12222000005282
9	Chassis assembly	1	12222000005267
10	Front panel	1	12222000A01431
11	Air outlet grille	1	12222000007904
12	Axial flow fan	1	12100105000084
13	Brushless DC Motor	1	11002015000247
14	Supporter subassembly of fan motor	1	12222000005162
15	Left side plate assembly of cabinet	1	12222000006665
16	Partition board assembly	1	12222200001156
17	Room Temperature Sensor	1	11201007000039
18	Top cover assembly	1	12222500000587
19	Electronic control box subassembly	1	17222300A01927
19.1	Cover of electronic control box	1	12122000006905
19.2	Main control board subassembly	1	17122300A01917
19.4	Electronic installing box	1	12122300000170
19.7	Inverter control board subassembly	1	17122000A16230
19.7.1	Radiator	1	11203803000677
20	Terminal board subassembly	1	17222000A31351
20.1	Wire joint	2	17400401000135
20.2	Terminal board	1	12222300000033
20.3	Terminal board	1	12222300000032
21	4-way Valve Assembly	1	15422300000604
21.1	4-way valve	1	15500216000361
21.2	Gas valve	1	15500204000049
21.4	Muffler	1	15500506000007
22	Liquid valve Assembly	1	15422000A01491
22.1	Liquid valve	2	15500208000028
22.2	Electronic expansion valve subassembly	2	15500213000046
23	Liquid valve assembly	1	15422300000405
23.1	Liquid valve	1	15500208000047
24	Copper nut	3	15500406000010
24	Copper nut	3	15500406000012
24	Copper nut	3	15500406000016
26	DC Inverter Rotary Compressor	1	11103020000179
27	Reactor	1	17400306000058
27	Reactor	1	17400306000070
29	Discharge Temperature Sensor	1	11201007000246
30	Electric heating tube	1	17402002000043
31	NA	1	17402001000119
33	Low Pressure Valve assembly	1	15422000A01487
33.1	Gas valve	2	15500204000021
34	Suction pipe	1	15122300001047
39	Accumulator cylinder	1	15500508000315
41	Drain pipe	1	12100509000059
43	accessory	3	15500307000001
99	Compressor wire subassembly	1	17401203000939

---

Due to ongoing product improvements, specifications and dimensions are subject to change and correction without notice or incurring obligations. Determining the application and suitability for use of any product is the responsibility of the installer. Additionally, the installer is responsible for verifying dimensional data on the actual product prior to beginning any installation preparations.

Incentive and rebate programs have precise requirements as to product performance and certification. All products meet applicable regulations in effect on date of manufacture; however, certifications are not necessarily granted for the life of a product. Therefore, it is the responsibility of the applicant to determine whether a specific model qualifies for these incentive/rebate programs.

*Comfort-Cire*®  **Century**®

1900 Wellworth Ave., Jackson, MI 49203 • Ph. 517-787-2100 • [www.marsdelivers.com](http://www.marsdelivers.com)

